

## Consultation summary report – August 2024

### Background

An updated design for the Glen Innes Hospital Redevelopment was released in May 2024, in response to market escalation and to ensure the redevelopment could be delivered within the available budget. The project scope now includes new infrastructure for the emergency department, medical imaging, ambulance bays, and a new main entrance and car parking with access from Ferguson Street. The new building will be linked to the existing hospital ensuring all services remain connected onsite. The updated site plan is included below.

The design process explored many options for delivering the aims of the redevelopment and includes future expansion zones to allow a staged approach to deliver the full master plan. This stage of the redevelopment will improve flows throughout the hospital for patients and staff. The demolition of the old nurses building that was completed in late 2023 will allow for a construction staging zone and support the delivery of the full master plan in the future. The Spanish Flu Building will be retained in this stage of the redevelopment and access for the neighbouring Museum will remain from Ferguson Street.



**Image: Updated site plan for the Glen Innes Hospital Redevelopment**

## Consultation

Throughout June and July 2024, the project team sought feedback on the updated design through face-to-face and virtual meetings, and two community drop-in sessions in Glen Innes. Feedback was also encouraged and received online until 12 August 2024.

The community drop-in sessions were promoted via advertisement on the front page of the Glen Innes Examiner on 18 July 2024, media release dropped to local media on 15 July 2024, staff and stakeholder newsletters issued on 15 July 2024, physical flyers displayed at the Hospital, Community Centre and Glen Innes Severn Council and a social media post on Hunter New England Local Health District Facebook page on 23 July 2024 which was shared to local community Facebook pages.

12

staff and stakeholder meetings held

60

people attended the drop-ins

1535

views on the website pages

Your feedback	Our response
Pleased to see the redevelopment is proceeding, however disappointed we are not getting a new hospital in full.	The global increase of building costs faced by the construction industry has had a significant impact on what can be delivered within budget for the Glen Innes Hospital Redevelopment. The updated design delivers on priority areas now and ensures all existing services can continue onsite. There is a future development zone included in the design to allow a staged approach the deliver the full master plan, subject to additional funding being allocated.
Ensure travel distances are minimised for the elderly or disabled and ensure adequate parking near the front entry.	Noted. Wherever possible travel distances for patients, visitors and staff are minimised. Parking will be further developed in the next stage of the design.
This is a better design than before.	There are some advantages of this design over the previous scheme, particularly having all acute services on the same level and a new emergency department located at the main entry.
Consider access for people self-presenting to emergency.	There will be a drop-off bay at the main entry and the emergency department is the first department located next to the main entry.
A new inpatient unit was the priority over a new emergency department.	The clinical priorities for this redevelopment were determined in consultation with the Local Health District. Feedback received during the planning and design to date has supported this.
Safe and secure parking for staff, and safe access from the staff accommodation to the new building.	Noted, this will be further developed in the next stage of the design.
Happy to see the future has been planned for.	The design allows for future growth and expansion. The removal of the old nurses quarters has provided for a construction staging zone as well as potential space for future development.
Get construction to start and be finished asap.	Noted. We are working on finalising the design as soon as possible and will seek a builder through a competitive tender process forecast to occur in early 2025.
Did the cost of the demolition of the old nurses quarters result in the project being revised?	The main impact to the project has been the global escalation of building costs. To ensure the project remains within the allocated budget, a quantity surveyor provides advice to the project team regularly.
Pleased that the Museum access is being retained as is.	The Spanish Flu Building will be retained in this stage of the redevelopment and access for the neighbouring museum will remain as is from Ferguson Street.
Would like to see more doctors and clinical staff within Glen Innes.	While not related to the redevelopment project the project team has noted this feedback and will pass onto the Local Health District and the Ministry of Health.



Images above: Community pop-ups held on 24 and 25 July 2024 at Mackenzie Mall

### What's next?

The project team will continue to work with staff and stakeholders to develop the detailed design over the coming months. The project team anticipate releasing a competitive tender in early 2025 to engage a builder to commence construction in 2025.

If you have a question or would like to know more, email:

[HI-Gleninnes-Redevelopment@health.nsw.gov.au](mailto:HI-Gleninnes-Redevelopment@health.nsw.gov.au)

Further information on the project is also available at:

[www.hneinfra.health.nsw.gov.au/projects/gleninnes](http://www.hneinfra.health.nsw.gov.au/projects/gleninnes)

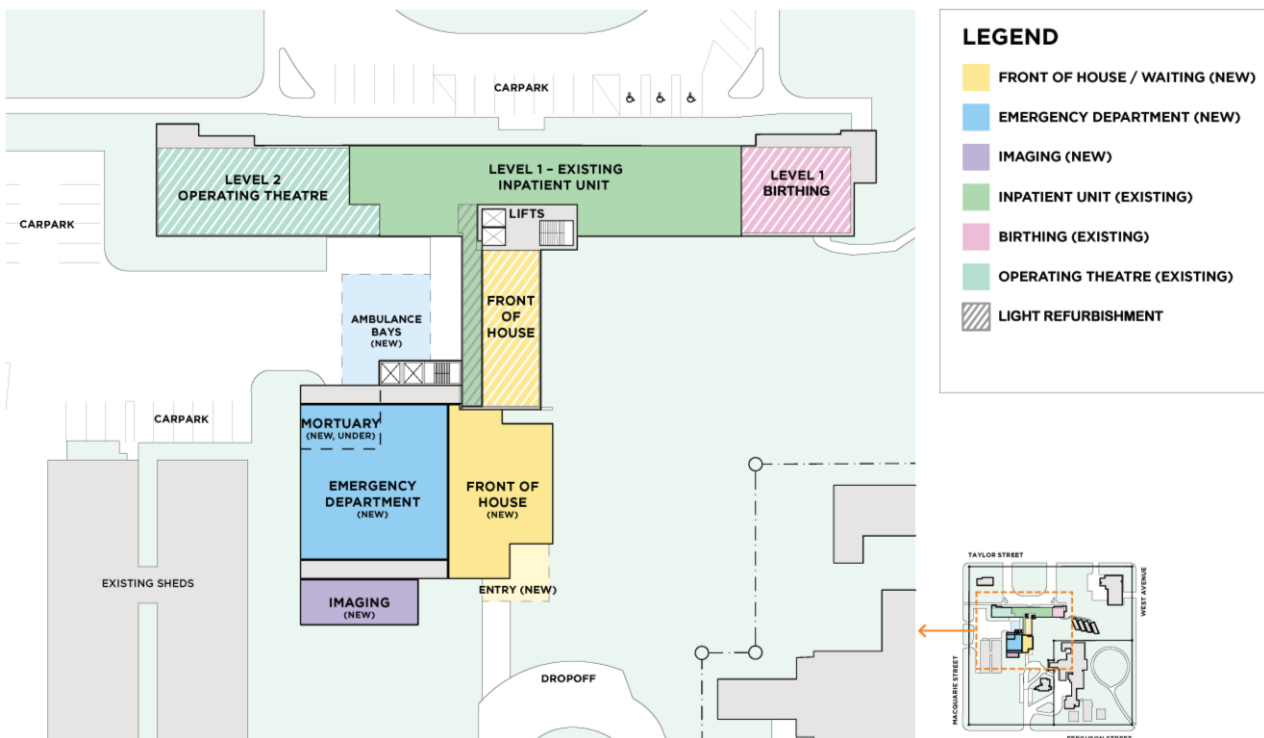

CONCEPT DESIGN - MAY 2024

Image: Updated design for the Glen Innes Hospital Redevelopment